

3295 RIPON ROAD

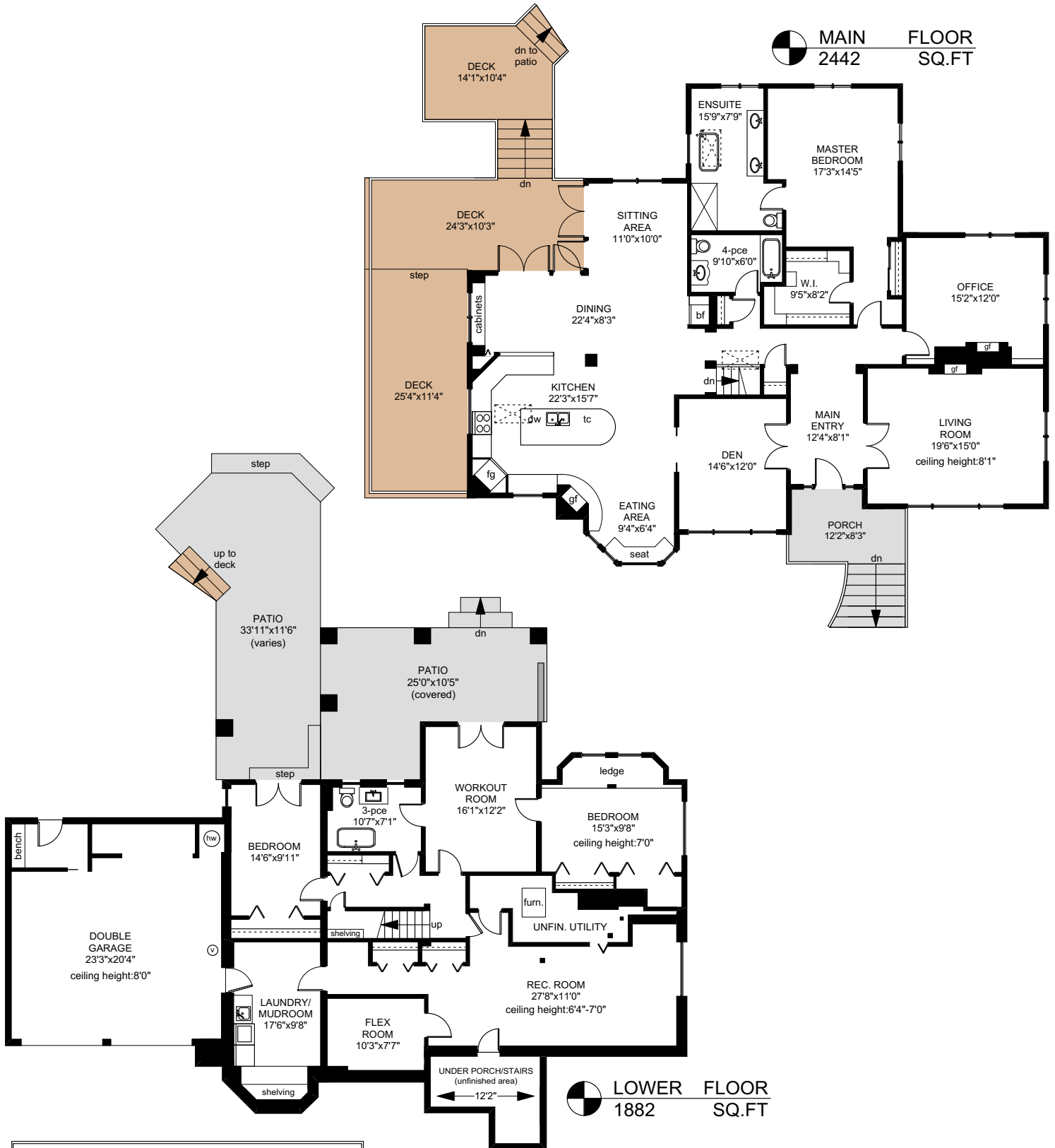

MAIN FLOOR
2442 SQ.FT

LOWER FLOOR
1882 SQ.FT

	FINISHED SQ. FT.	UNFINISHED SQ. FT.	TOTAL SQ. FT.
MAIN	2442	0	2442
LOWER	1647	235	1882
TOTAL	4089	235	4324
GARAGE	0	625	625
DECKS	0	667	667
PATIOS	0	717	717
PORCH	0	93	93

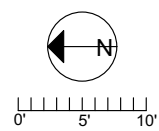

PREPARED FOR THE EXCLUSIVE USE OF
BRETT JONES OF NEWPORT REALTY

MEASURED ON: 06/26/18
DRAWING FILE: 17214

Tafe Measure VICTORIA, B.C.
Ph. 883.8894
www.tafemeasure.com